

police station // 07

- doors
- windows
- walls

one meter

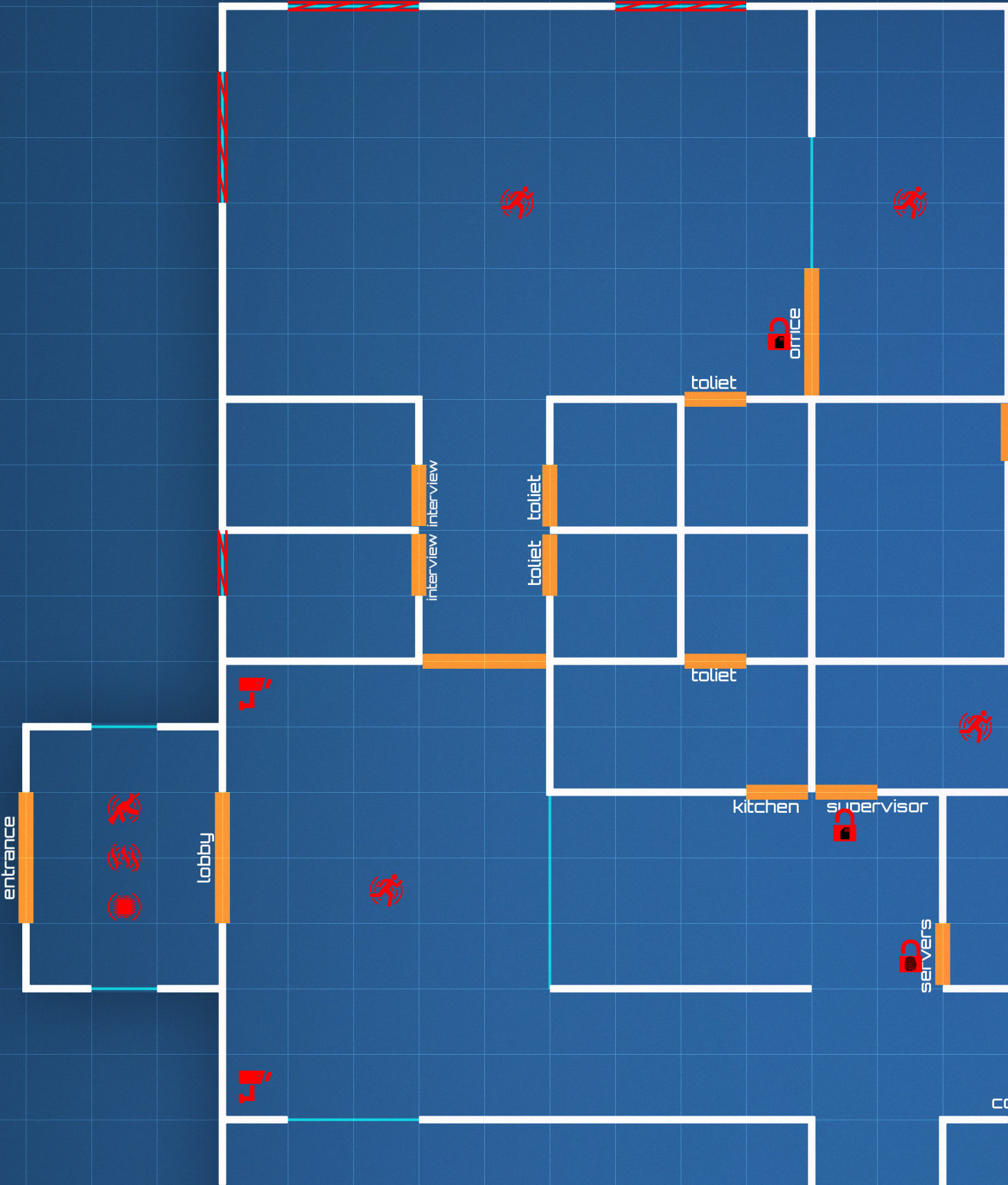

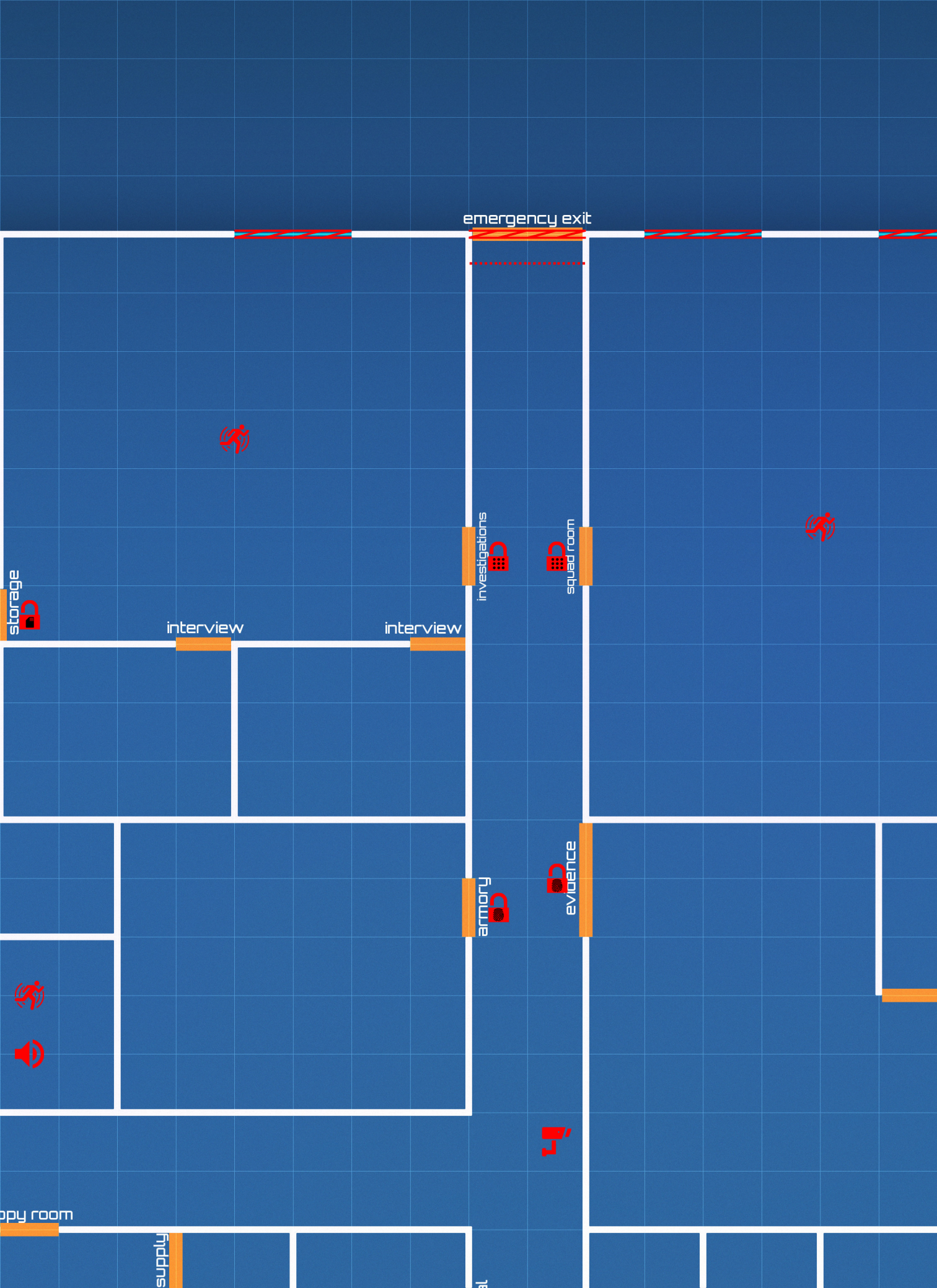

emergency exit

investigations

squad room

interview

interview

armory

evidence

supply

al

copy room

storage

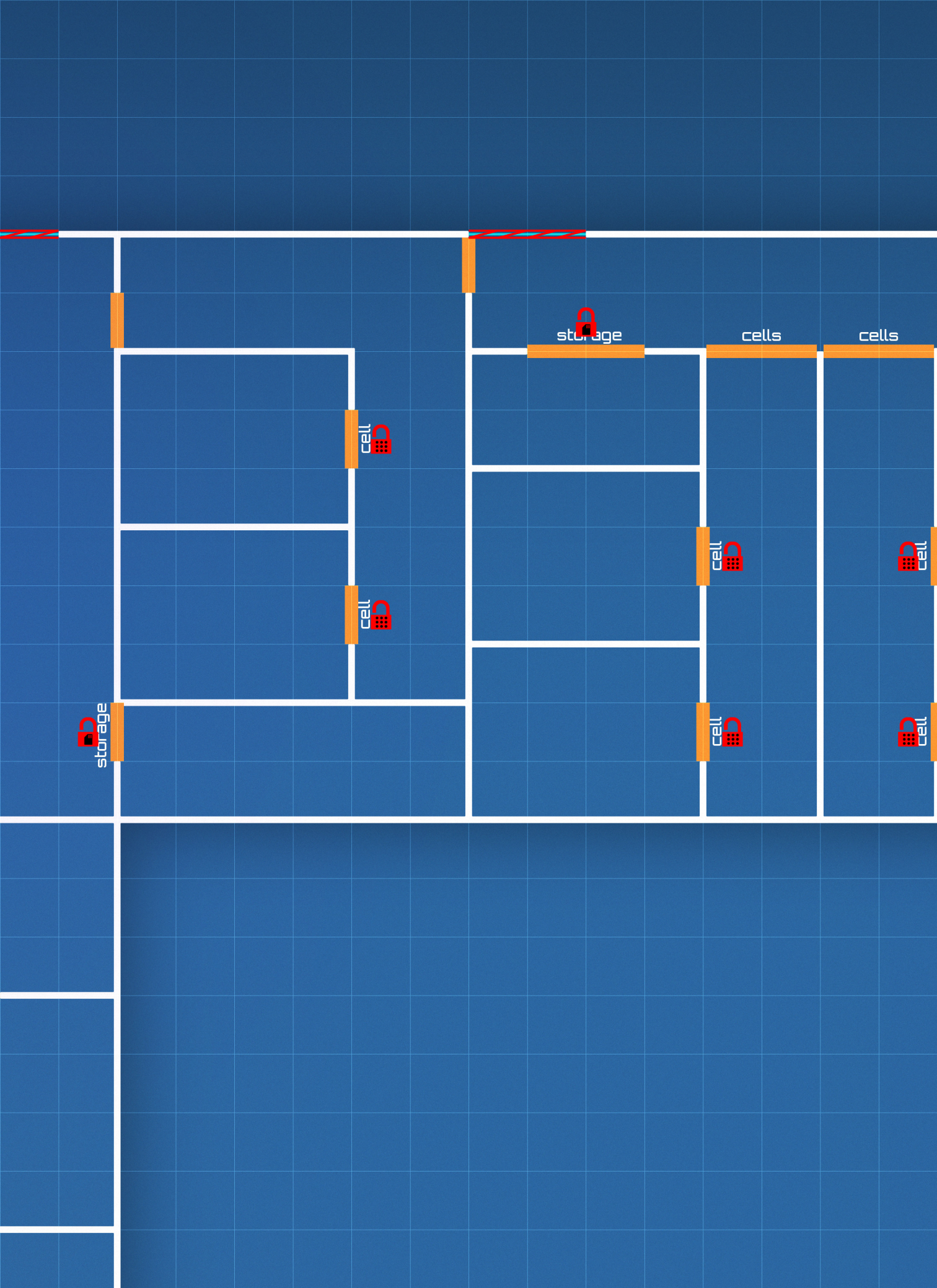

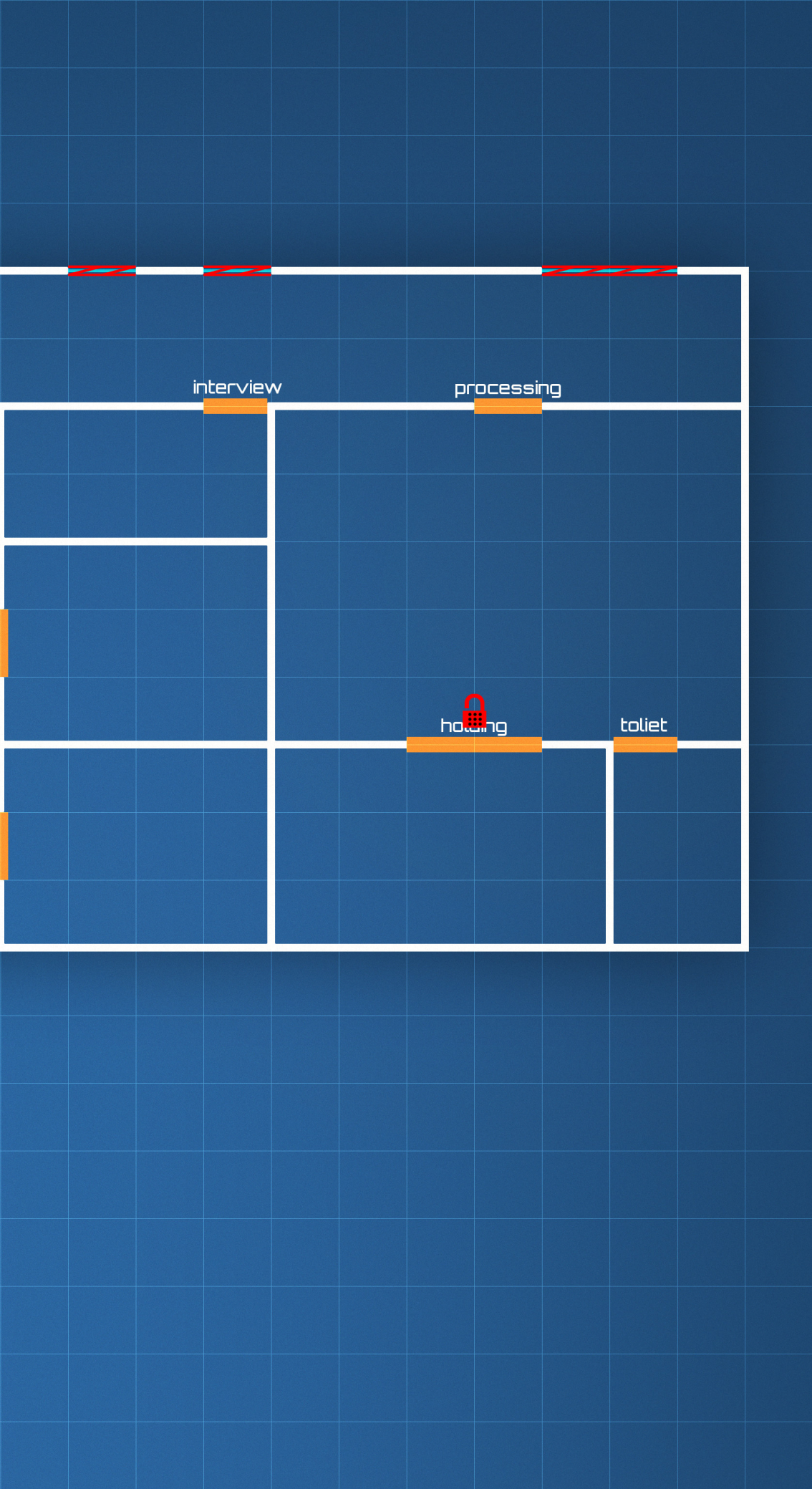

interview

processing

holding

toilet

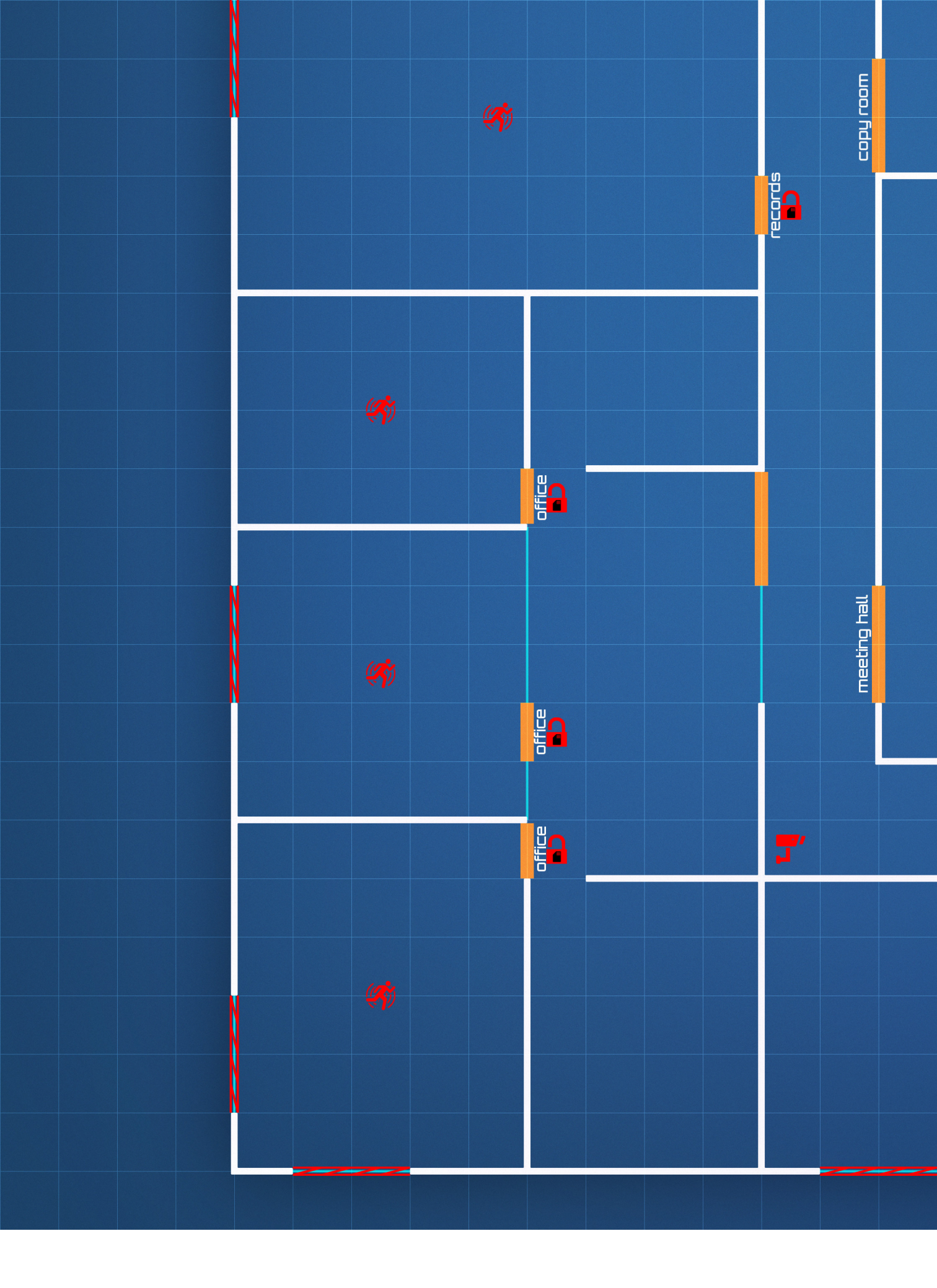

copy room

records

meeting hall

office

office

office

i

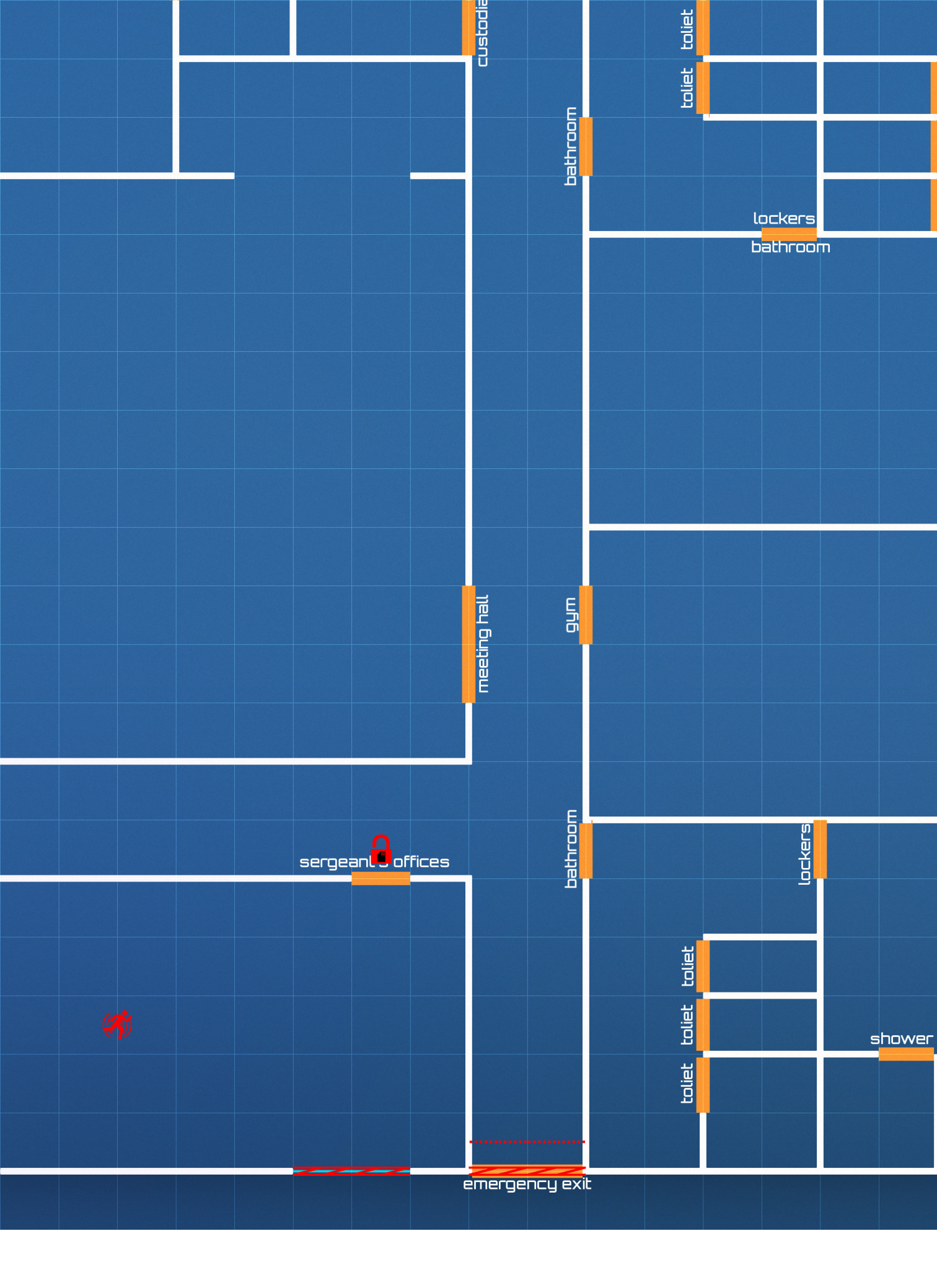

custodial

toilet

toilet

bathroom

lockers
bathroom

meeting hall

gym

bathroom

lockers

sergeant's offices

toilet

toilet

toilet

shower

emergency exit

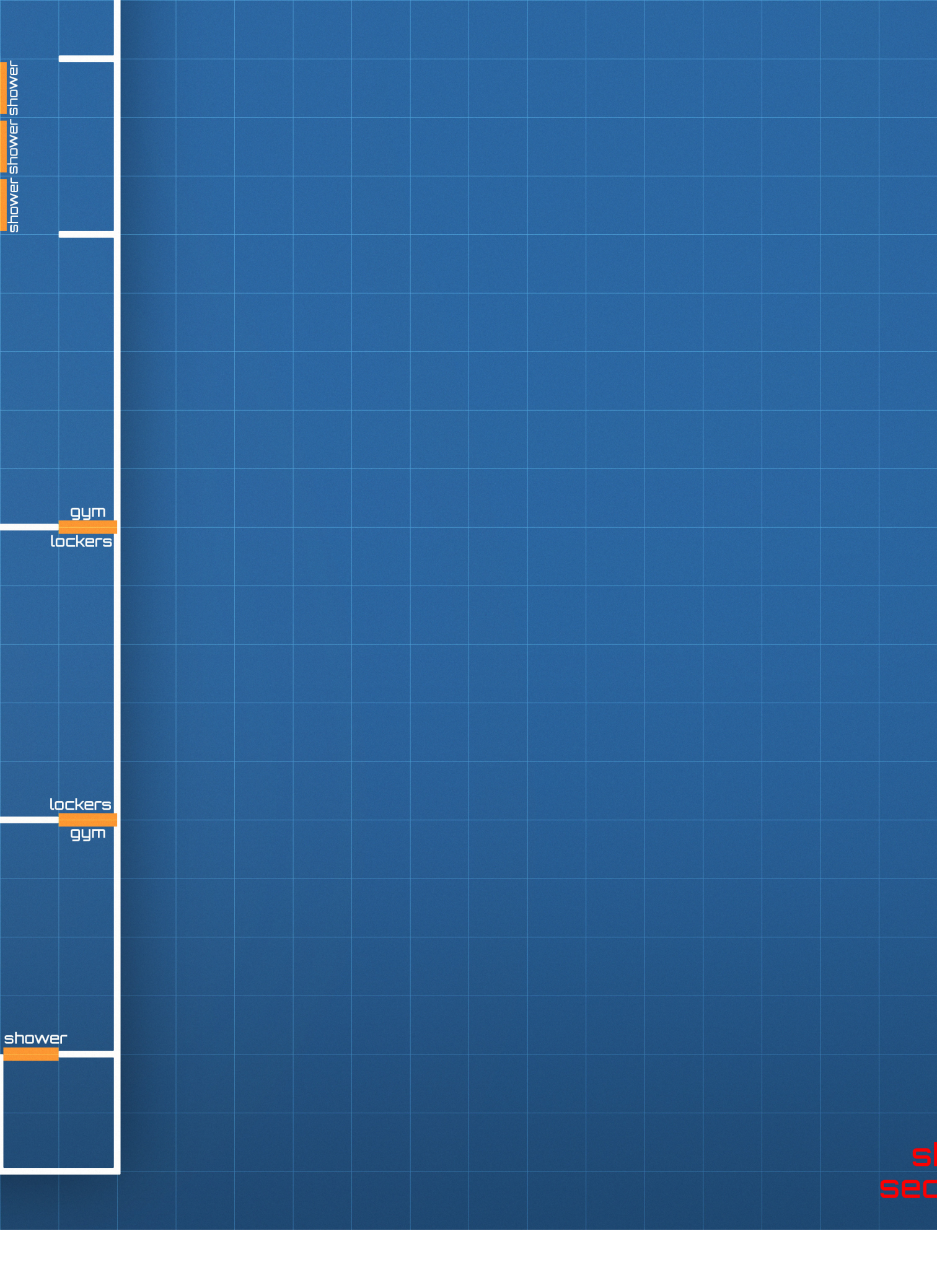

shower shower shower

gym

lockers

lockers









gym

shower









sh
SEC

[legend]

detection.

- | | | | |
|---|-------------------------------|---|---|
|  | pressure sensor
[SFX] 3001 |  | Magnetic Anomaly Detector
[SFX] 3002 |
|  | camera
[SFX] 3003 |  | Millimeter Wave Detector
[SFX] 3004 |
|  | trip beam
[SFX] 3005 |  | motion sensor
[SFX] 3006 |
|  | wire alarm
[SFX] 3007 |  | olfactory scanner
[SFX] 3008 |
| | |  | sound detector
[SFX] 3009 |

locks.

- | | | | |
|---|---------------------------|---|----------------------------------|
|  | cardreader
[SFX] 3010 |  | facial recognition
[SFX] 3011 |
|  | keypad
[SFX] 3012 |  | dna scanner
[SFX] 3013 |
|  | transponder
[SFX] 3014 |  | voice recognition
[SFX] 3015 |
|  | key
[SFX] 3016 |  | print scanner
[SFX] 3017 |